

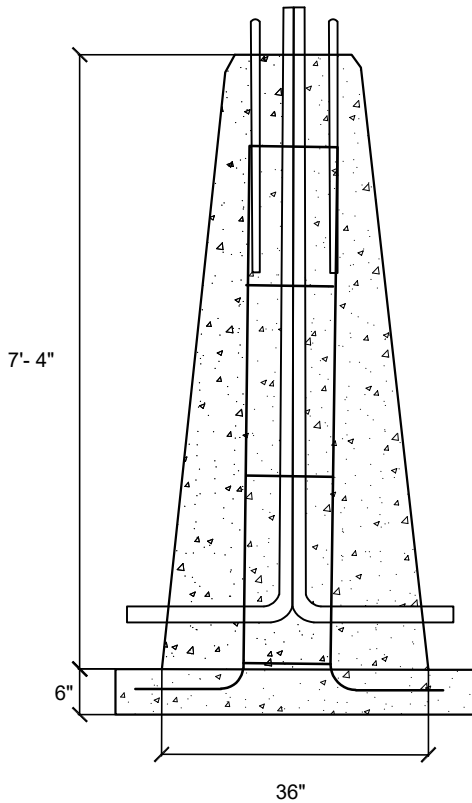

LIGHT POLE FOOTINGS



ITEM #C19.201 (7' -4")
WEIGHT 6100 LB

BASE (OPTIONAL)
WEIGHT 1150 LB

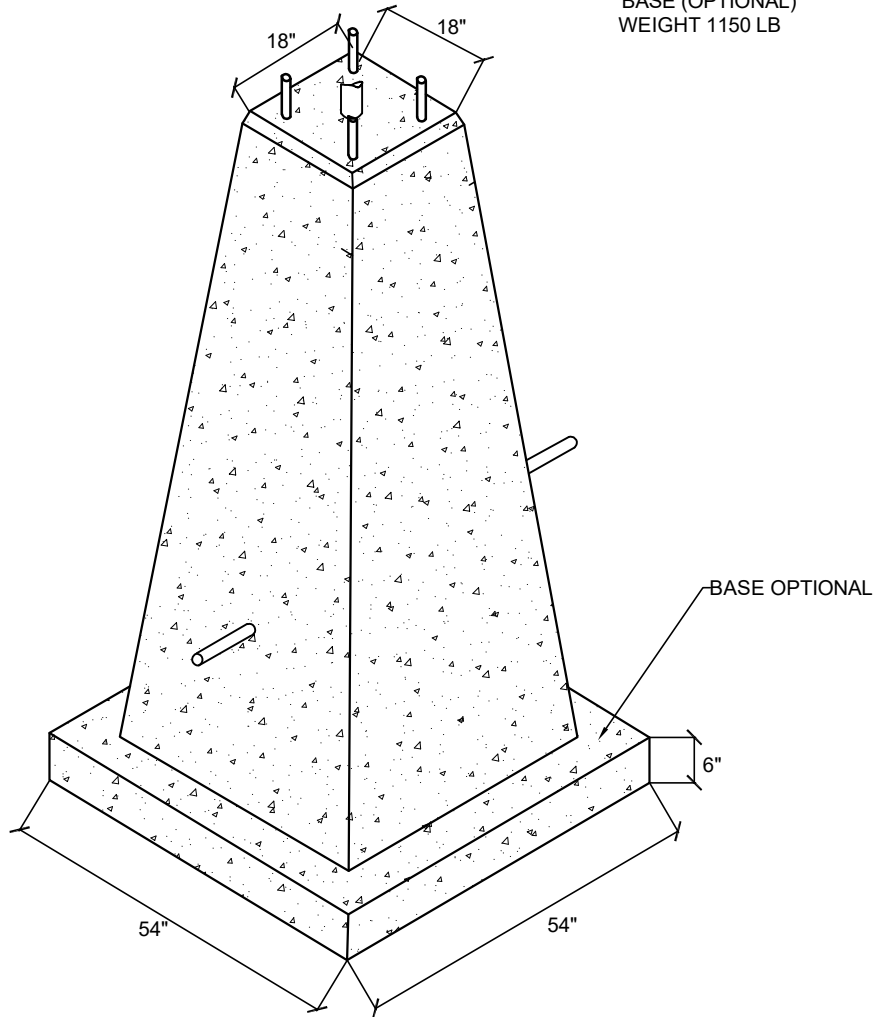

SPECIFICATIONS:
5000 psi AT 28 DAYS
AIR ENTRAINING 5-7%
10mm REBAR REINFORCING
CONDUIT SIZE AND LOCATION AS
PER CUSTOMER SPECIFICATIONS

NOTES: QUICK INSTALLATION RESULTS IN MINIMAL DISRUPTION OF TRAFFIC
DEPTH OF CONCRETE FOOTINGS BELOW GRADE MINIMIZES FROST MOVEMENT
CAN BE PRODUCED WITH GALVANIZED CORNER PROTECTOR